

148X210mm

148X210mm

148X210mm

148X210mm

148X210mm

148X210mm

## MLIGHT Universal Truck Side Steps

### Tools Needed:

- Phillips screw driver x2 (both long and short)
- Power Drill, drill bits (1/8", 1/4", 3/8")
- Center punch
- Ratchet with socket
- Small round file
- Open end wrench
- Black marker

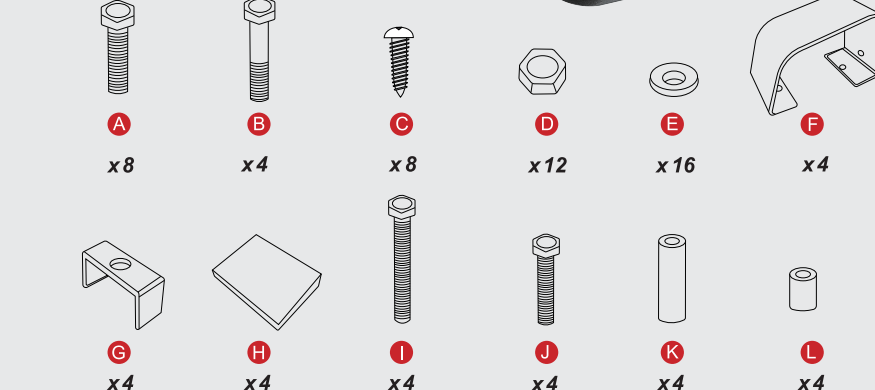

A, M8\*30 Hexagon Bolt  
E, M8 Washer  
C, Self Tapping Screw  
G, "U" Shaped Spacer  
D, M8 Nut  
H, Plastic Wedge Spacer

For Ram 09-18 Models Only:

L, M8\*70 Hexagon Bolt  
J, M8\*50 Hexagon Bolt Full Thread  
K, Long Spacer  
L, Short Spacer

### Notes

- Do not install this product to your vehicle if the vehicle's body metal is rusted or otherwise damaged.
- Before drilling any holes, be sure the area is clear of any obstacle.
- Do not modify step or installation hardware. Use step only on vehicles listed on application chart.
- Use steps to enter and exit vehicle only.

### Before Installation:

Check your vehicle's body metal (rocker panel) underneath to determine which group your vehicle's body belongs to. Follow the instructions for your vehicle only.

#### Vehicle Body Style Group Diagram

##### GROUP A

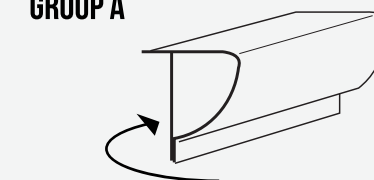

Flat Wall

##### GROUP B

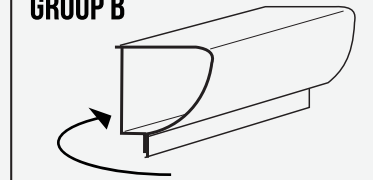

Flat Wall with Bent Angle

##### GROUP C

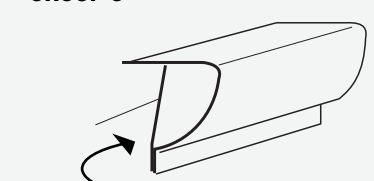

Inclined Wall

##### GROUP D

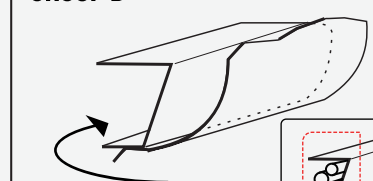

Wall with a Channel

### Installation Instructions:

- Find a proper position to mount the step.

**Note:** For correct placement, the center of the step should be in line with the front edge of the seat's frame, also the step's mounting plate should be able to lay flat against the vehicle's rocker panel.

#### INSTRUCTIONS FOR GROUP A,B, and C :

- Mark a vertical line on the pinch weld flange of the rocker panel. Measure 4 1/16" out on each side of the line and mark those points.

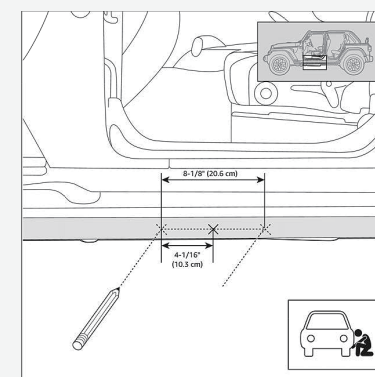

- Drill a 3/8" hole on these points. Before drilling make sure you center the 3/8" drill bit on the flange, use a center punch and 1/8" drill bit to drill a pilot hole for best results.
- Place the step in its mounting position and make sure it is level. Mark a point on each of the step's legs through the 3/8" holes just drilled.
- Remove the step and use a 3/8" drill bit to drill a hole on marked points on the step.
- See below for the rest of the installation.

#### GROUP A

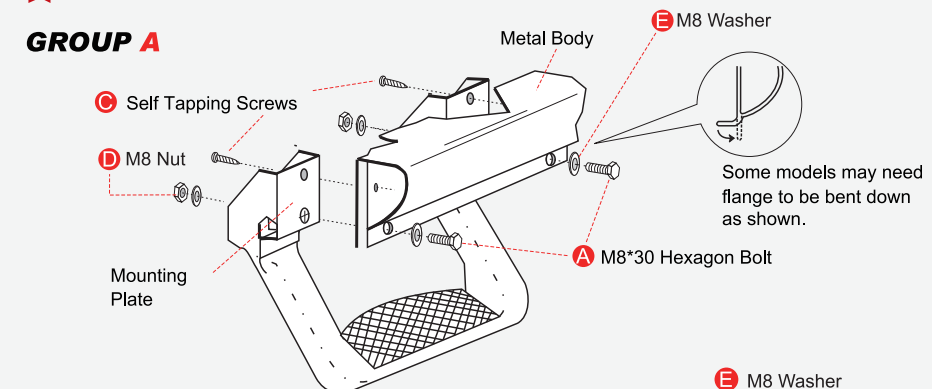

#### GROUP B

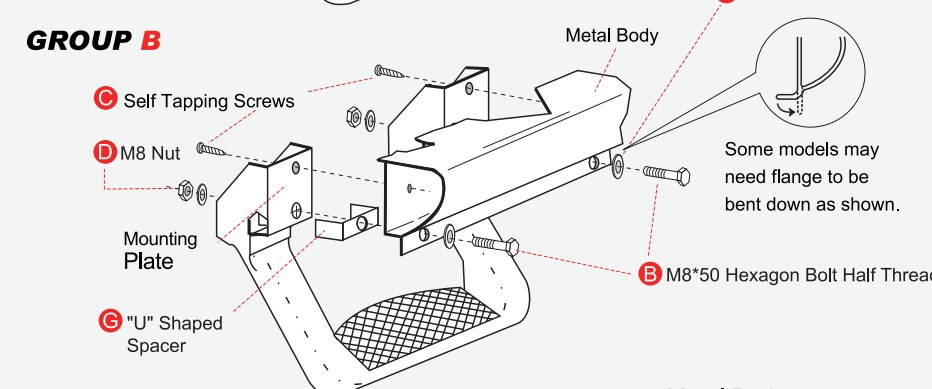

#### GROUP C

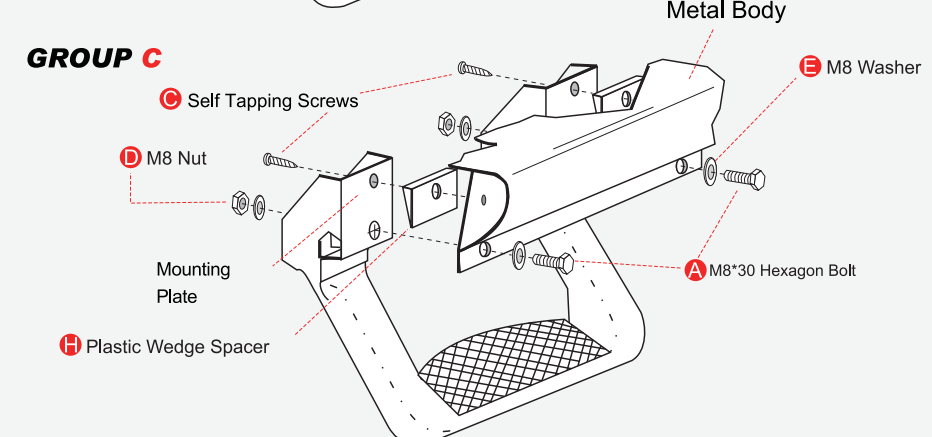

#### INSTRUCTIONS FOR GROUP D and E:

- Mark a vertical line on the pinch weld flange of the rocker panel. Measure 4 1/16" out on each side of the line and mark those points.

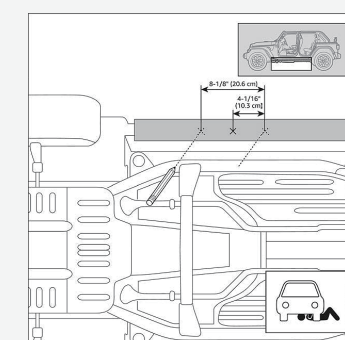

#### GROUP D

- Drill a 3/8" hole on these points. Before drilling make sure you center the 3/8" drill bit on the flange, use a center punch and 1/8" drill bit to drill a pilot hole for best results.
- See below for the rest of the installation.

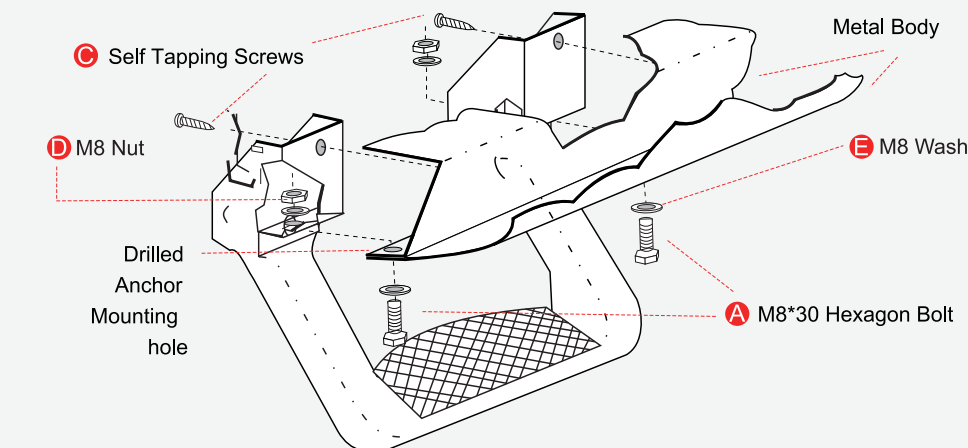

**Note:** If the "A" do not go in flush, you may need to use a small round file to file the opening.

#### GROUP E

**Note:** If the mounting plate does not reach the rocker panel, "F" should be used to perform this procedure.

- Along the outside lines, measure 1/2" (measure 1/4" for Suburban) inward from the inside edge of the pinch weld and mark a point on each of the two lines. Use a center punch with 1/8" drill bit to drill pilot holes. Then drill a 3/8" hole at these two points.
- Position "F" inside the rocker panel and drill a 3/8" hole on it through the pinch weld flange hole.
- Attach "F" to the step using "C" through the top step holes and small holes on "F". Align "F" with the step edges. Mark a point on the step through the lower hole on "F".

- Remove "F" from the step, the distance between the marked points on the step should be 8 1/8". Drill a 3/8" hole through the marked points on the step.
- Maneuver "F" back into position. Insert "A" and "E" through the 3/8" holes on the pinch weld. Hold the bracket firmly and mark a point on the vehicle's body metal through the top hole on "F". Remove "F" from position.
- Remove the plastic door entry cover and move the wire harness aside. Drill a 1/8" hole through the marked points on the body metal.
- Install "F" back into the mounting position. See below for the rest of the installation.

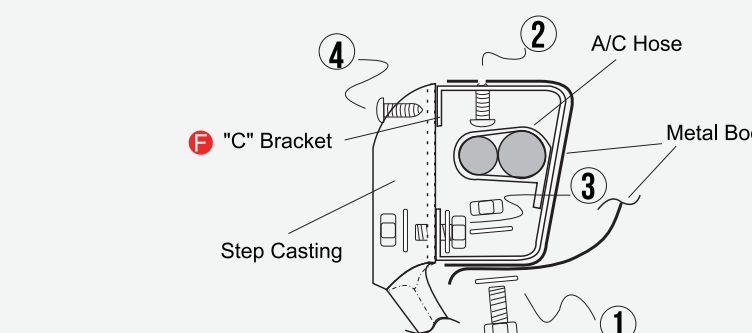
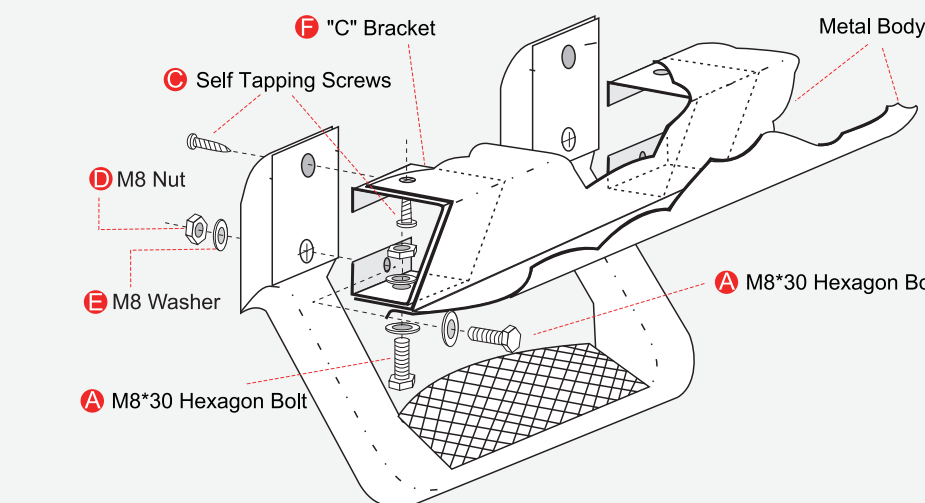

FOR Ram 09-18 (1500&2500/3500) models only

**Note:** Drilling required

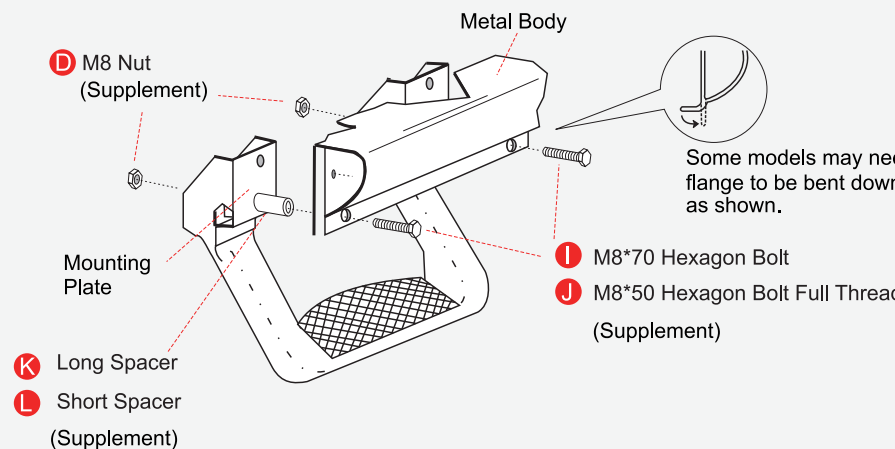

For applications that require hole to be drilled

- Measure 2" from the bottom of the hole already drilled out and 1 1/16" from the edge and mark the spot.
- Drill out the hole using a 11/32" drill bit.
- Verify supplied screw fits thru the hole.

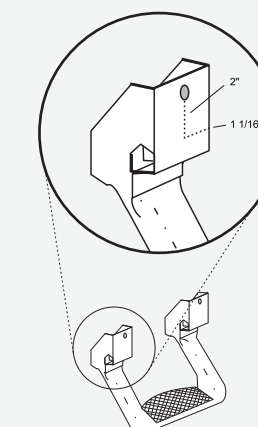

### Enjoy Your New Mlight Truck Side Steps!



可印刷三折页样式