

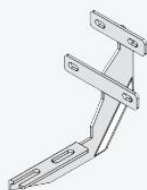

## Slip-Proof Running Boards

- For 2015-2023 Ford F-150 SuperCrew Cab
- For 2017-2023 Ford F-250 F-350 Super Duty

### Tools Required



A  
X6



B  
X18



C  
X18



D  
X18



E  
X12



F  
X12

A.X6 Mounting Bracket  
B.X18 M8 Hexagon Nut  
C.X18 M8 Flat Washer

D.X18 M8 Lock Washer  
(Pre-Install on Step Bar)  
E.X12 M8 Hexagon Flange Bolt  
F.X12 M8 Flat Washer

### Notes

- Read this instruction carefully before starting installation.
- Verify the direction of brackets before starting installation.
- Proper tools will improve the quality of installation and reduce the time required.
- If missing parts or any damage found, please take a picture and contact us.

## ***Installation Instruction***

### **1** Step1

- (1) Locate (3) mounting positions each side.
- (2) Remove the paint buildup on the factory threaded studs.
- (3) Clean the sealant and dirt around mounting positions.

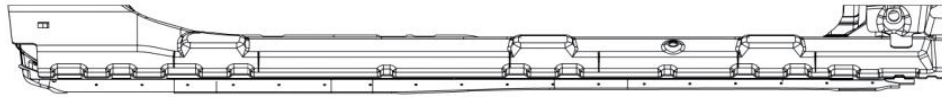

Driver Left Side



Front

### **2** Step2

- (1) Attach bracket to the inner rocker panel, feed the factory studs through the holes on mounting bracket.
- (2) Secure the mounting bracket with (3) M8 flat washers, (3) M8 lock washers, (3) M8 hex nuts.
- (3) Repeat to install all brackets. Do not fully tighten.

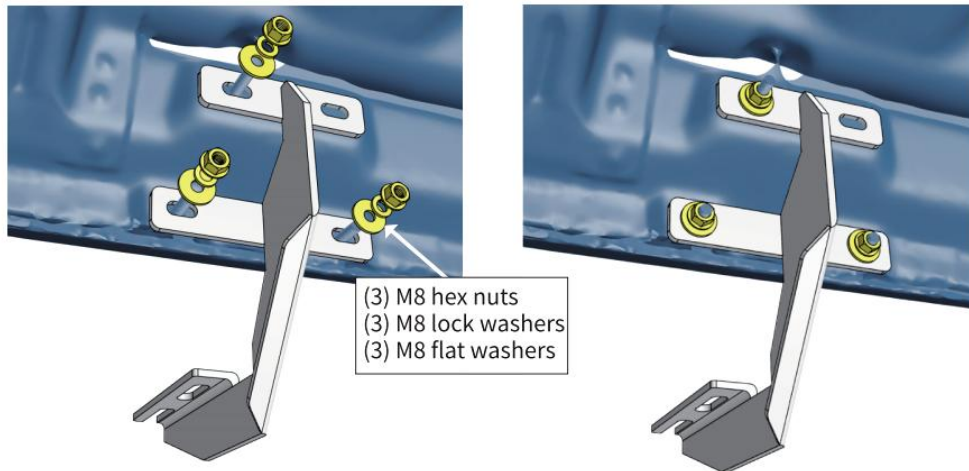

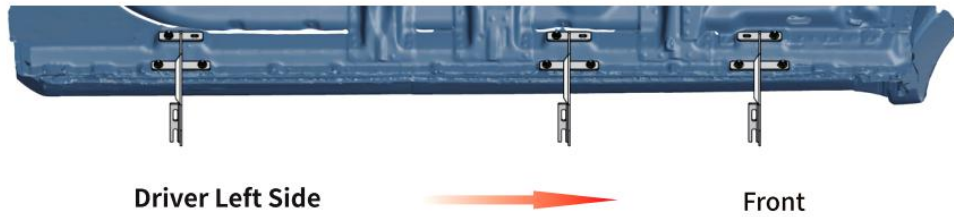

**3**

### Step3

- (1) Remove (6) M8 hex bolts and (6) M8 flat washers underneath the step bar.
- (2) Slide mounting track to proper positions.
- (3) With assistance, take the step bar to brackets.  
Secure the step bar on brackets with (6) M8 hex bolts and (6) M8 flat washers.
- (4) Repeat to install the other side step bar, do not fully tighten.

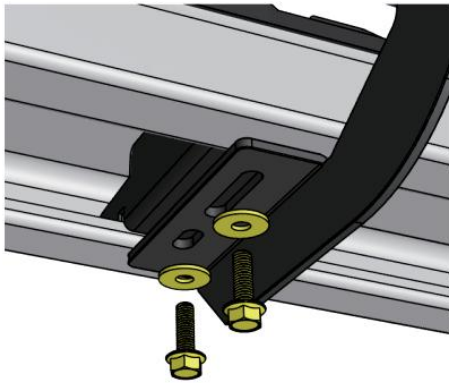

Stainless Steel Step Bar

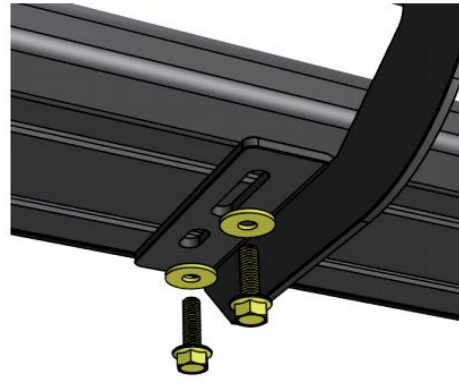

Aluminum Alloy Step Bar





Driver Left Side

Front

**4**

#### Step4

- (1) Tighten M8 hex nuts on vehicle with 15ft-lbs. torque.
- (2) Adjust the step bar to level and tighten M8 hex bolts with 15 ft-lbs. torque.
- (3) After the step bar installed, periodic check to ensure all mounting hardware remains secure and tight.

***Enjoy Your new Nilight Running Boards !***

