

840X285MM

210x285mm

210x285mm

210x285mm

210x285mm

210x285mm

210x285mm

210x285mm

210x285mm

MIGHT Pickup Truck Rear Bumper

For 2007-2018 Wrangler JK

Tools Required:

- 19mm/16mm/ 13mm Socket
- 6mm Hex Bit
- Plastic remove tool
- Ratchet
- Torque Wrench

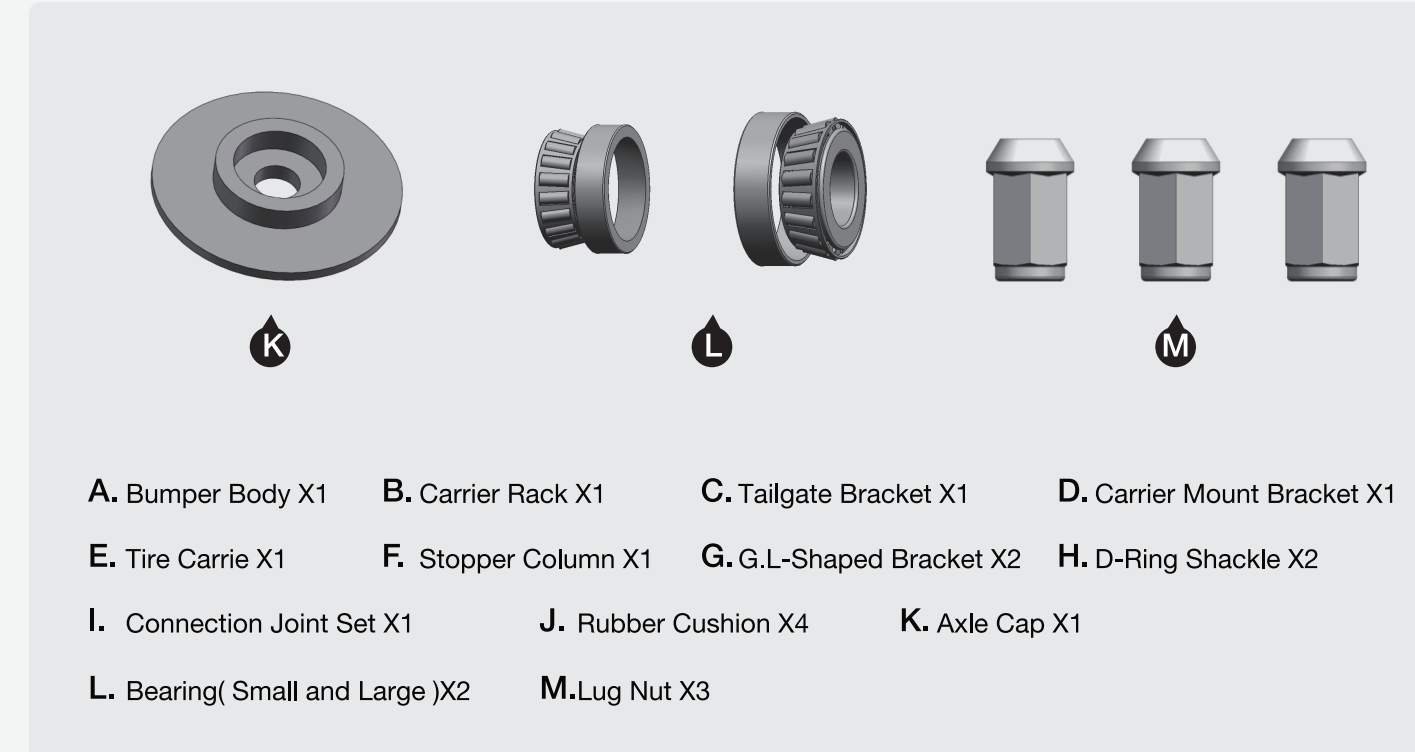

Notes

- Read this instruction carefully before starting installation.
- Proper tools will improve the quality of installation and reduce the time required.
- If missing parts or any damage found, please take a picture, and contact us.

Factory Bumper Removal

- Remove factory rear bumper, this includes all tow hitch receivers and recovery hooks. Open the tailgate and locate the plastic vent on the inside of the door. Remove the vent by lightly prying on the upper left corner of it until it pulls out. Be careful not to force the vent out or break it.
- Once the vent is off, locate the small wiring harness just inside the vent and unclip it. This is the wire to the factory third brake light.



- Remove the rubber plug and wire from the tailgate that is connected to your rear brake light. The plug should pull through if you disconnected the wires correctly. If it is not coming out easily, help the rubber fitting from the inside of the tailgate by pushing from the rear and pulling at an angle downward at the same time.
- Remove the factory spare tire carrier by removing the 8 bolts (13mm) attached to the tailgate.

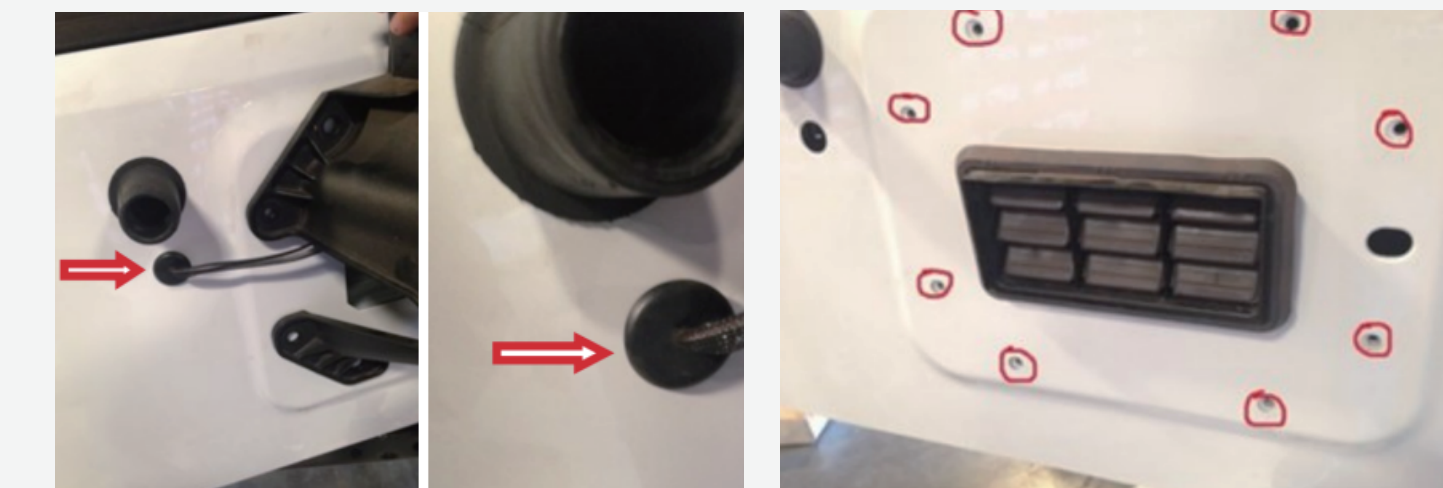

Installation instruction

- Take the L-shaped bracket and place it into body frame rail. Guide the bracket to align the weld nut with the oval hole on frame rail. Driver side is shown, repeat on passenger side.

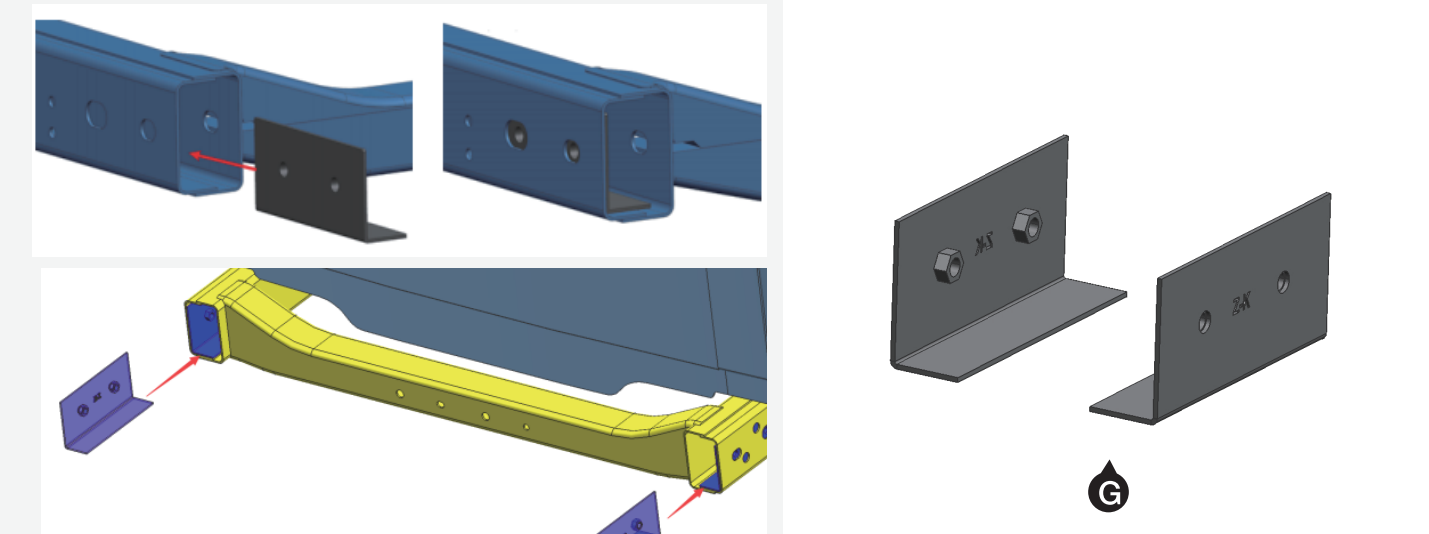

- With assistance, lift and attach rear bumper to the rear cross member. Secure the bumper to frame rail using 4 M12x30 hex bolts, 4 M12 flat washers, 4 M12 lock washers. Driver side is shown, repeat on passenger side.

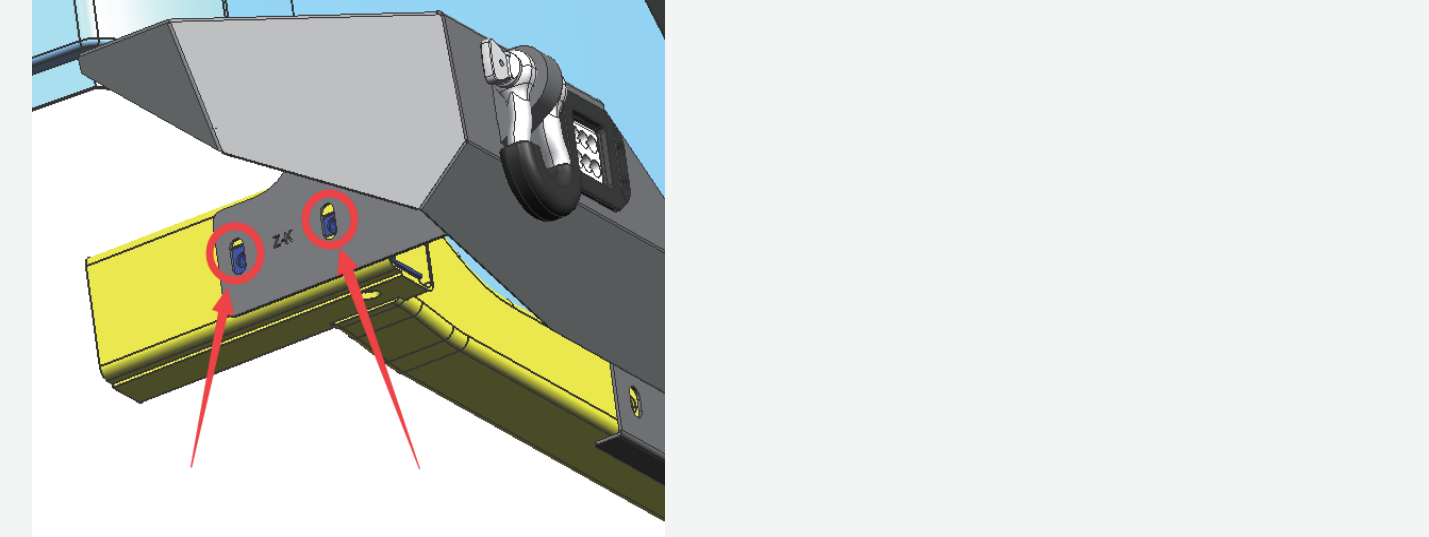
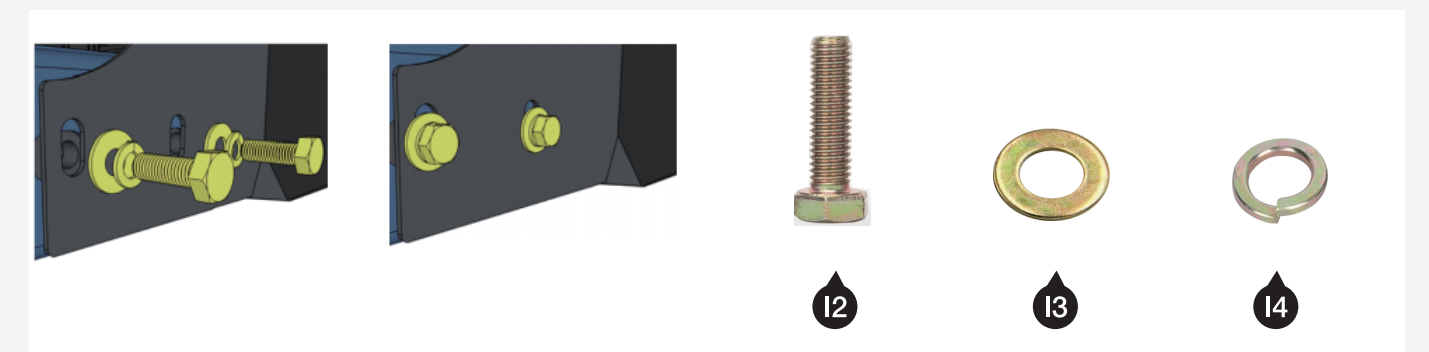

- Insert the M12x110 hex bolts from the inner side of the cross member. Secure the trailer hitch to cross member using 4 M12x110 hex bolts, 8 M12 flat washers, 4 M12 lock washers, 4 M12 hex nuts. Tighten M12 bolts and nuts to 60ft.lbs torque.

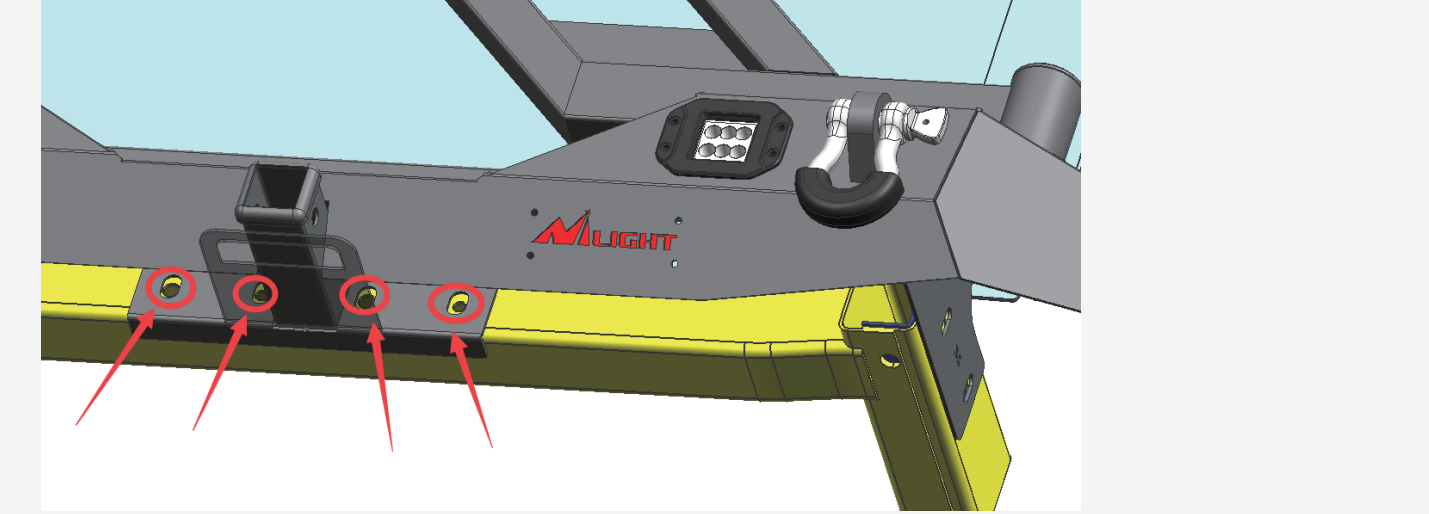
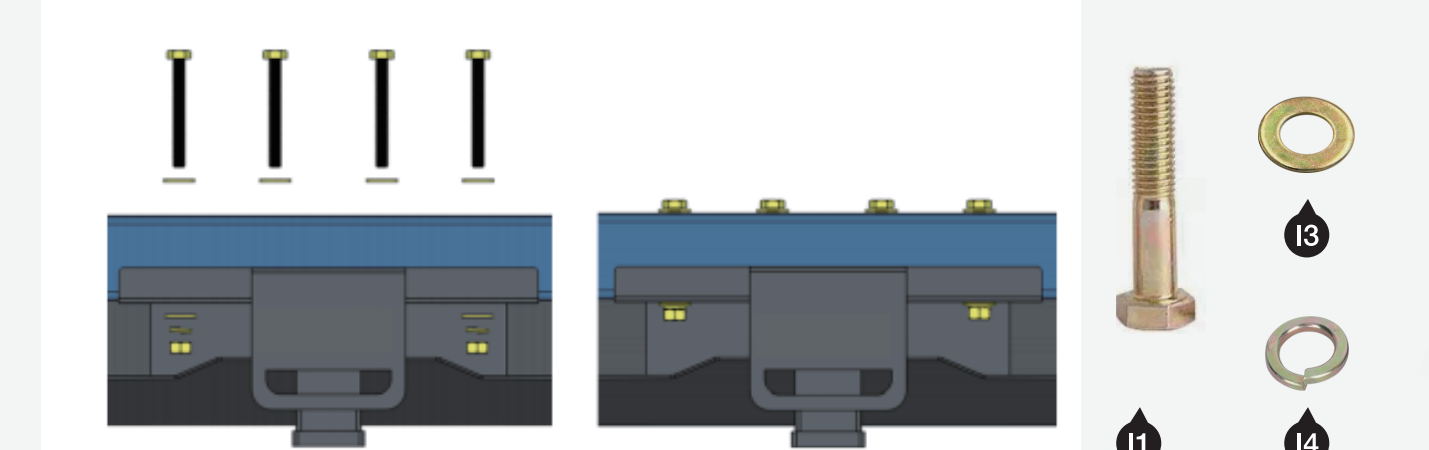

- Attach the tailgate bracket to the tailgate and secure with 8 M8 x 25 hex bolts. Assemble the tire carrier rack with stopper column and carrier mount bracket using 4 M12x30 hex bolts, 8 M12 flat washers, 4 M12 lock washers, 4 M12 hex nuts. Tighten M12 bolt and nuts to 60ft.lbs torque.

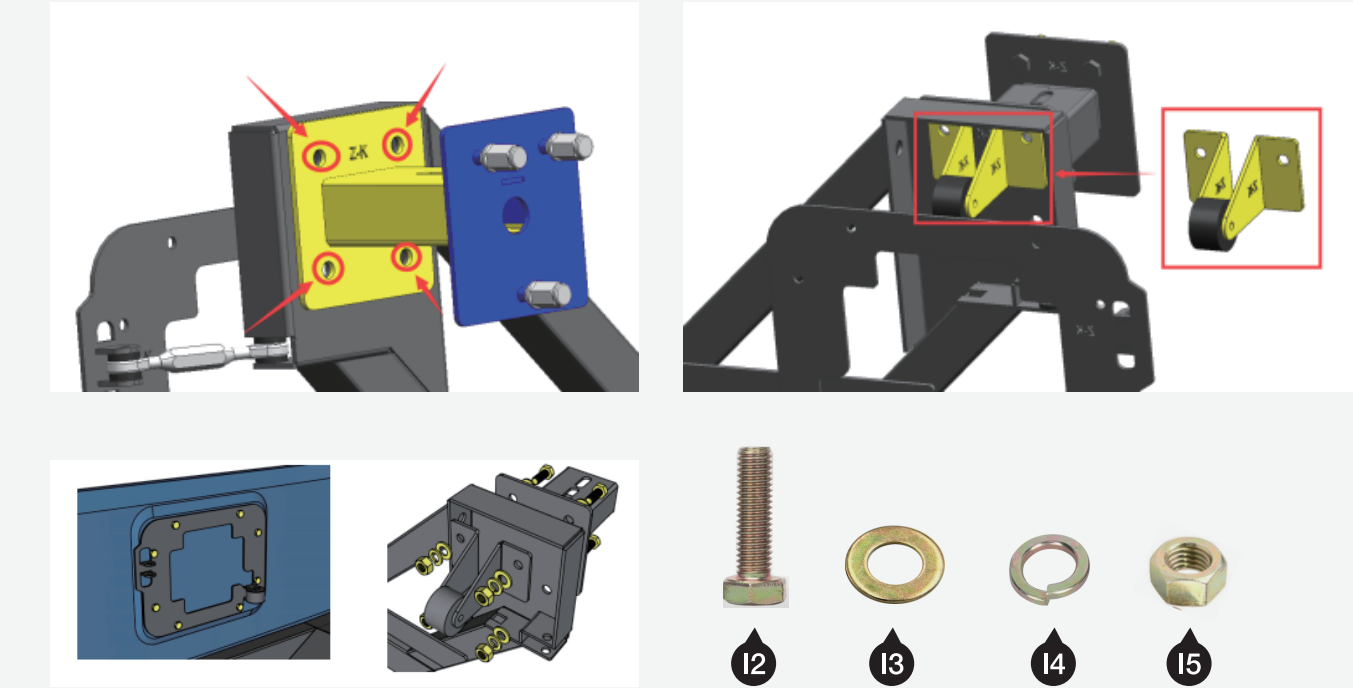
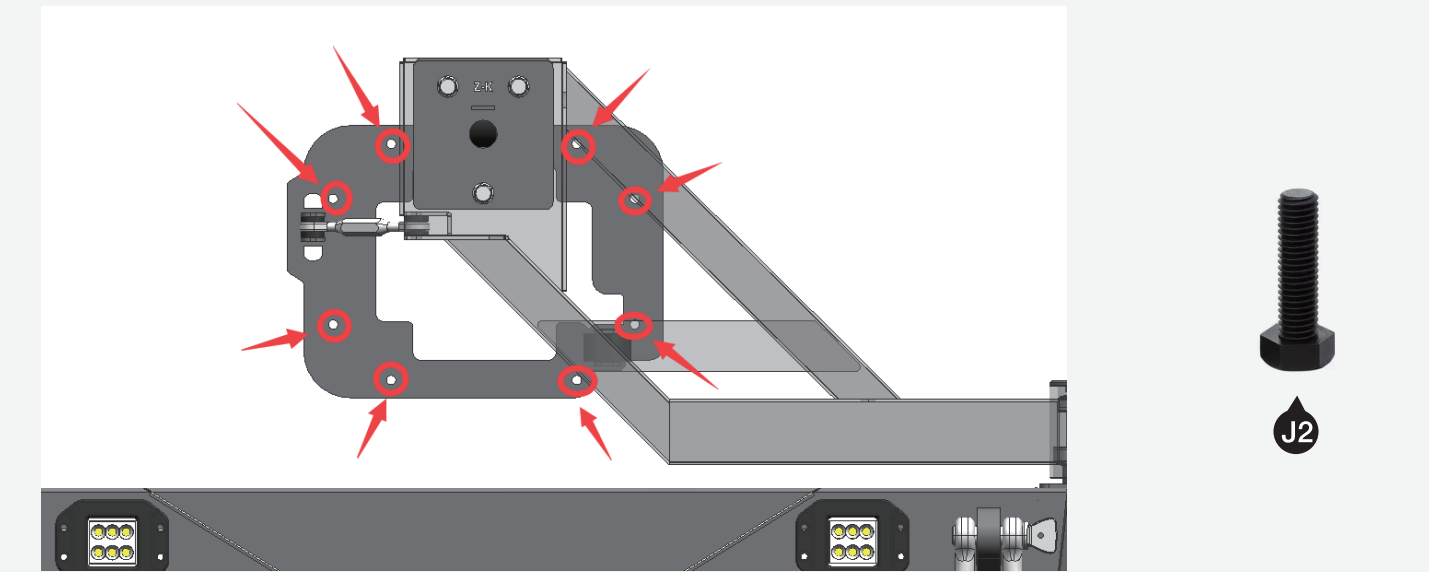

- Position the bearings and tie carrier rack to the axle. Secure the tire carrier rack using 1 M10 button head bolt, 1 M10 flat washer and 1 M10 Lock Washer.

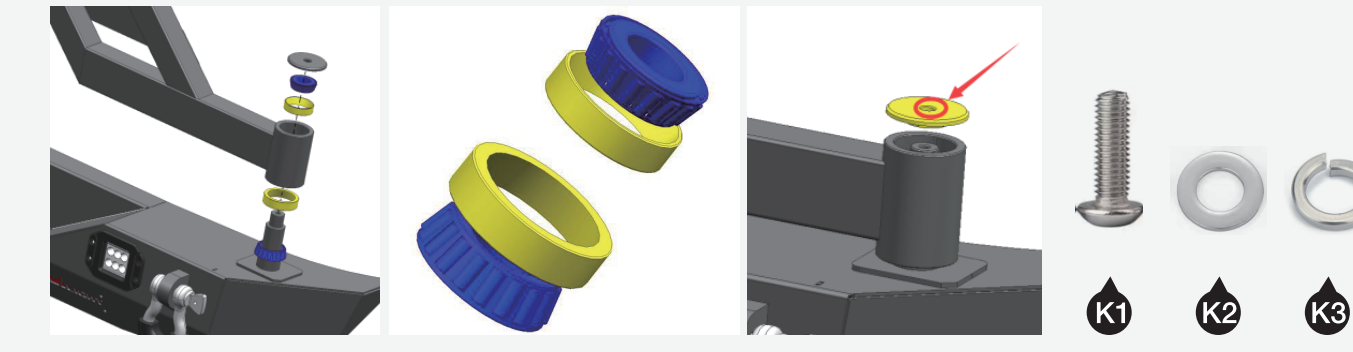

- Assemble the connection joint and adjust to proper length. Install the connection joint to the tailgate bracket and carrier rack using 4 rubber cushions, 2 M8x50 hex bolts, 4 M8 flat washers, 2 M8 lock nuts.

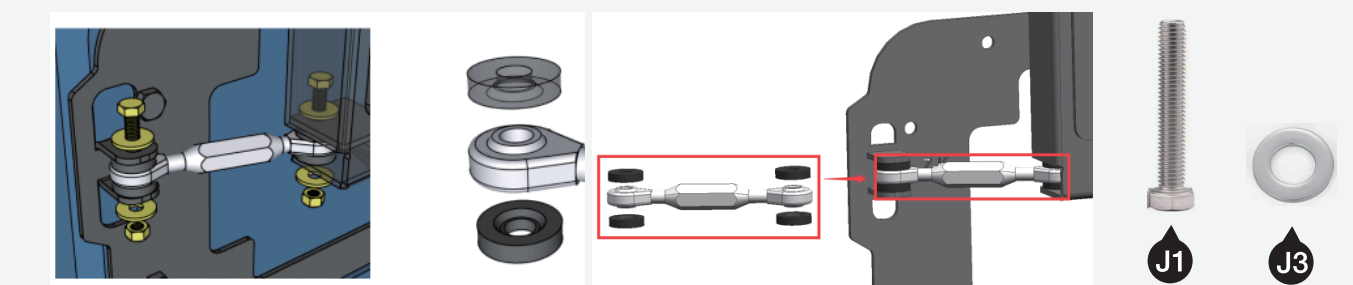

- Position the tire carrier to the carrier rack and secure with 2 M12x30 hex bolts, 2 M12 flat washers. Remove 3 lug nuts from tire carrier. Take the spare tire and place it onto tire carrier. Secure with 3 lug nuts.

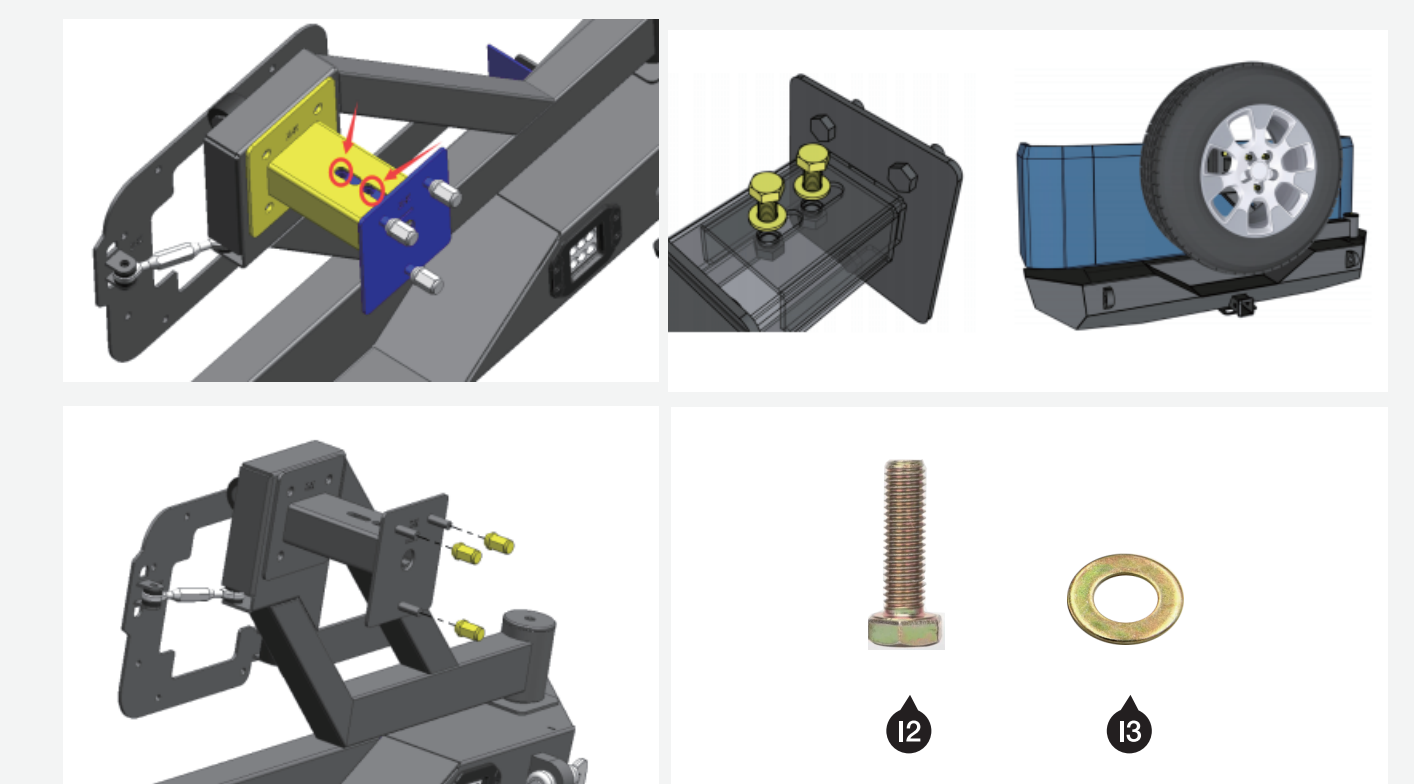

*The pictures may not match the actual product a bit, but the installation steps are the same.

Enjoy Your New MIGHT Bumper!

