

148X210mm

148X210mm

148X210mm

148X210mm

Need Help?



► Scan QR code to contact us

nilight.com/pages/contact

If you're having an issue with the product or need technical support, Nilight team is always here to help and make sure your **100% satisfaction**.



NILIGHT *Front & Rear Flat Fender Flares*

Contents:

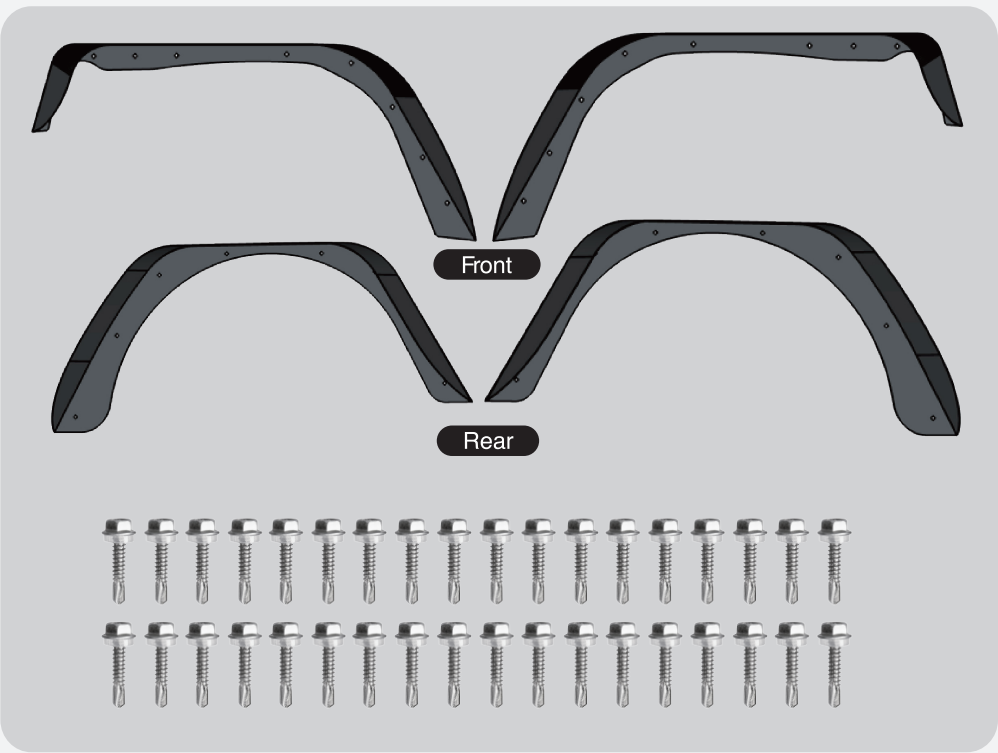

Tools Required: • 8mm Socket • Electric Drill • Ratchet

Lifting vehicle and removing tire is not necessary but does make it more comfortable. Not all holes may align, you may need to use a drill to widen them. Use caution. You may leave the stock inner liners on, it will require more tools to cut and mold them to the Nilight Fender Flares.

1 Step1

- (1) Disconnect side mark lights, twist bulb socket counter-clockwise.
- (2) Detach all hardware and remove front and rear fender flares.
- (3) Remove front fender extension.

2 Step2

Ensure body panels are clean before installation.

- (1) Attach front fender flare to the front fender panel.
- (2) Align front fender flare with the front fender panel margin-bottom.

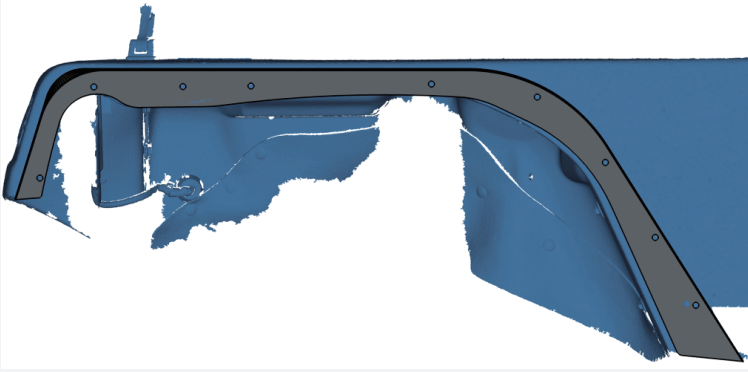

- (3) Secure the front fender flare on body panel with (9) M5x15 drilling screws.

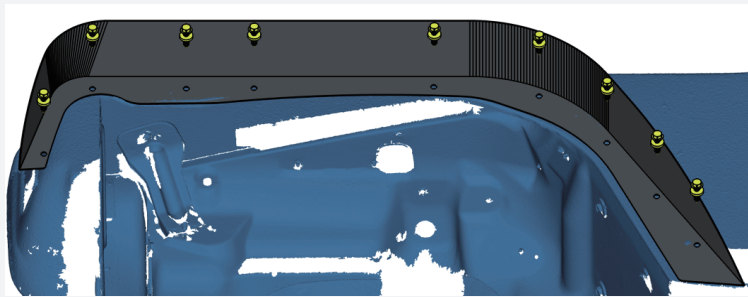

3 Step3

- (1) Attach rear fender flare to the rear body panel.
- (2) Align rear fender flare with the body panel margin-bottom.

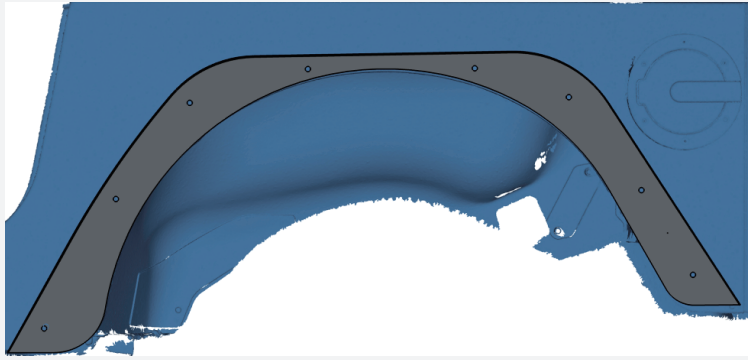

- (3) Secure the rear fender flare on body panel with (8) M5x15 drilling screws.

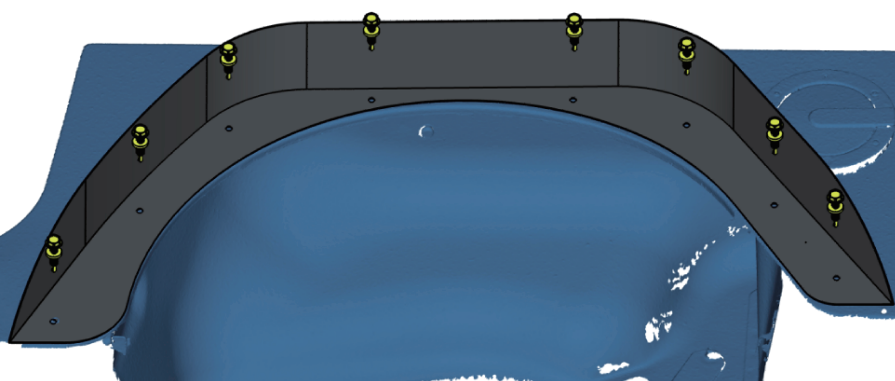

Enjoy your New Nilight Fender Flare!



Attention:

- (1) The product parts in this instruction may differ slightly from the actual product contents but generally does not affect the installation of the product.
- (2) Please feel free to contact us if you have any kind of question about your purchase. We will reply you in timely manner.