

Nilight *Wide Flat Front Fender Flares*

For 2007-2018 Jeep Wrangler JK

Front Fender Flares Accessories List

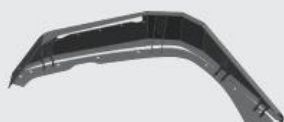

L-A x1



L-B x1



C x2



R-A x1



R-B x1



D x2



E x2



wrench x1



M6*12 x24



M6*20 x16



M6 x16



M6 x16



M6x24



Rivet nut x16



M8*25 x2



M8 x2



M8x2



M8x2



M5*12 x4



M5 x4



Light bracket x2



Rubber Strip x2



Riveter x1

Rear Fender Flares Accessories List

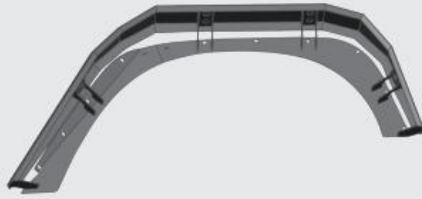

L-F x1

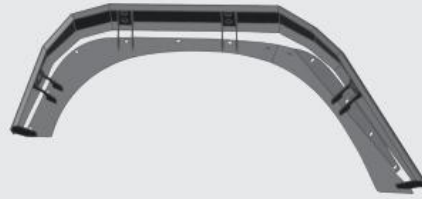

R-G x1



M6*20 x20



M6*20



M6*20



Rubber Strip x2



wrench x1



Rivet nut x20



Riveter x1

Installation Instruction

1 Front Fender Flares

Installation Instruction

Front Fender Flares

STEP 1: Front (Stock) Fender Flare Removal

Put on Safety Glasses. Remove the six bolts (circled) holding the fender flares and liner in place (Fig 1) using a 10mm socket and ratchet.(Fig 2)

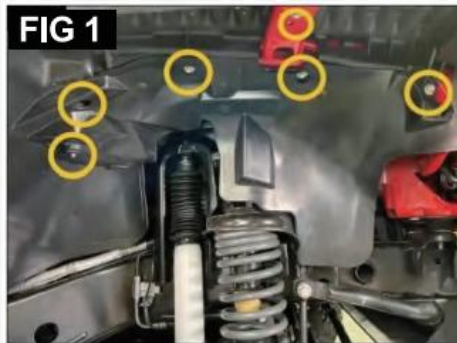

STEP 2:

Locate the wiring harness for the running lights and side markers. Release the clip (circled) and pull apart.(Fig 3)

At either front side, using even force and hands grasping the edge of the fender flares, pull directly away from the quarter panel.(Fig 4)

There will be tension on from the clips and you will find resistance until they release. Some clips may stay attached to the quarter panel.(Fig 5)

Remove any remaining clips attached to the panel with a pry tool and reattach to the fender flare.



STEP 3:

3-1: Install **Rivet Nut** in the corresponding holes on the car.

3-1-1: Insert the **rivet nut** into the mandre on the riveter and put into the hole. (Fig 6) (Fig 7)

Installation location:



Accessories:

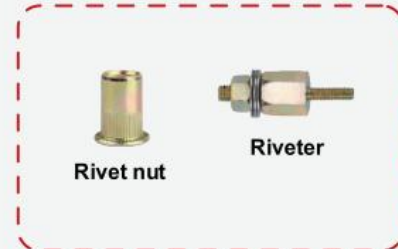

3-1-2: Rivet the **nut** into the place (until the nut is deformed). (Fig 8) (Fig 9)



Working principle of rivet nuts

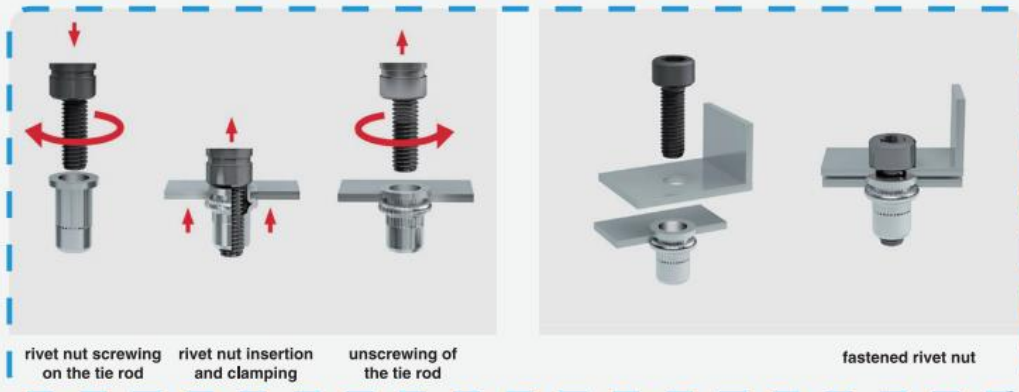

3-2: Install the **rubber strip** on the front fender flare. (Fig 10) (Fig 11)

Installation location:



Accessories:



3-2: Install the **rubber strip** on the front fender flare. (Fig 10) (Fig 11)

Installation location:

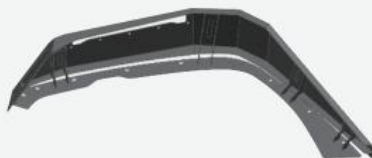

Accessories:



3-3: Install the **front fender flare** on the car, using **M6X20 screws**, **M6 rings** & **M6 washers**. Finally tighten all the screws with **wrench**.(Fig 12) (Fig 13)

Accessories:

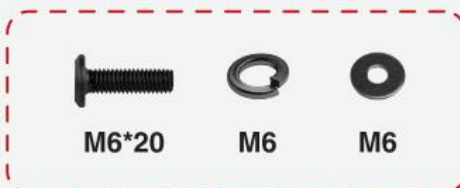
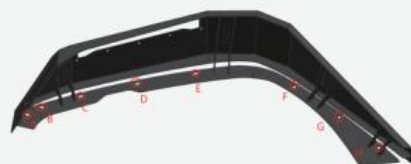

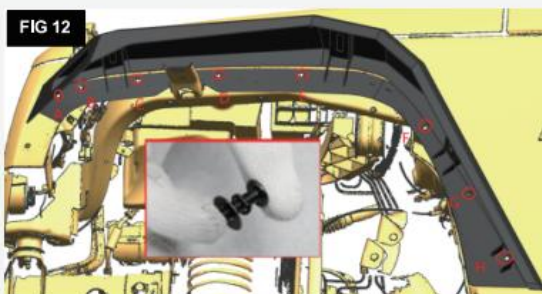

3-4: Assemble **L-A** and **L-B** with **M6X12**(Fig 14) (Fig 15) and **M6** nuts.

Installation location:



Accessories:



3-5: Install **C** onto **R-A** with **M6*12** screws & **M6** nuts. (Fig 16) (Fig 17)

Installation location:

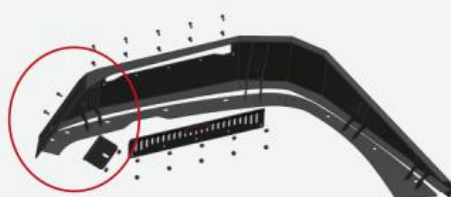

Accessories:





STEP 4: Install Driver Side Front Fender Flare

Note: Please check whether the light is working properly before installation.

4-1: Assemble the lamp with iwn screw package. (Fig 18-21)

Accessories:



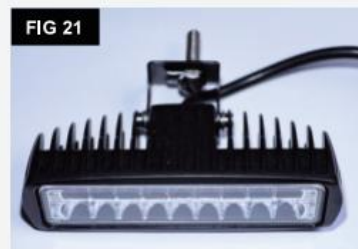

4-2: Install the assembled lamp of **4-1** onto the main body of **3-5** and tighten the screws.
(Fig 22) (Fig 23)



4-3: Connect the Switching interface of E to the vehicle wires. (Fig 24-25)

Accessories:



STEP 5: Install the passenger side fender in the same way.